

TEA POINT

MFC CONSTRUCTION WITH ABS EDGING TO CABINETS AND SHELVES. SOLID BACK BOARDS. CLIP ON PLINTHS WITH MATCHING END CAPS. WALL AND BASE UNITS COMPLETE WITH 1 NO. SHELF. WHITE CARCASSING. GLOSS WHITE LAMINATE DOORS, PLINTH AND VANITY PANELS. GLOSS WHITE CORNICE AND PELMET TO WALL UNITS. SATIN STAINLESS STEEL D-HANDLES. HOWDENS (OR SIMILAR APPROVED).

BASE UNITS:

1 no. 500  
1 no. 1000 SINK UNIT  
SOLID WOOD 40mm WORKTOP SQUARE FRONT EDGE, COLOUR: RUSTIC OAK

INSET STAINLESS STEEL SINGLE BOWL SINK AND DRAINER SEALED INTO WORKTOP. MONOBLOC MIXER TAP WITH THERMOSTATIC ANTI-SCALD CONTROLS TO M & E DETAILS. BASKET STRAINER WASTE. ARMITAGE SHANKS SANDRINGHAM SELECT (OR SIMILAR APPROVED) SINK TO BE COMPLETE WITH ALL NECESSARY BRACKETS AND FIXINGS FOR MOUNTING TO WORKTOP AND PIPEWORK FOR WATER SUPPLY AND CONNECTION TO FOUL DRAINAGE SYSTEM.

WHITE GOODS (FRIDGE / FREEZER & DISHWASHER) AS PART OF FIT OUT WORKS. WATER / DRAINAGE CONNEX FOR DISHWASHER ONLY.

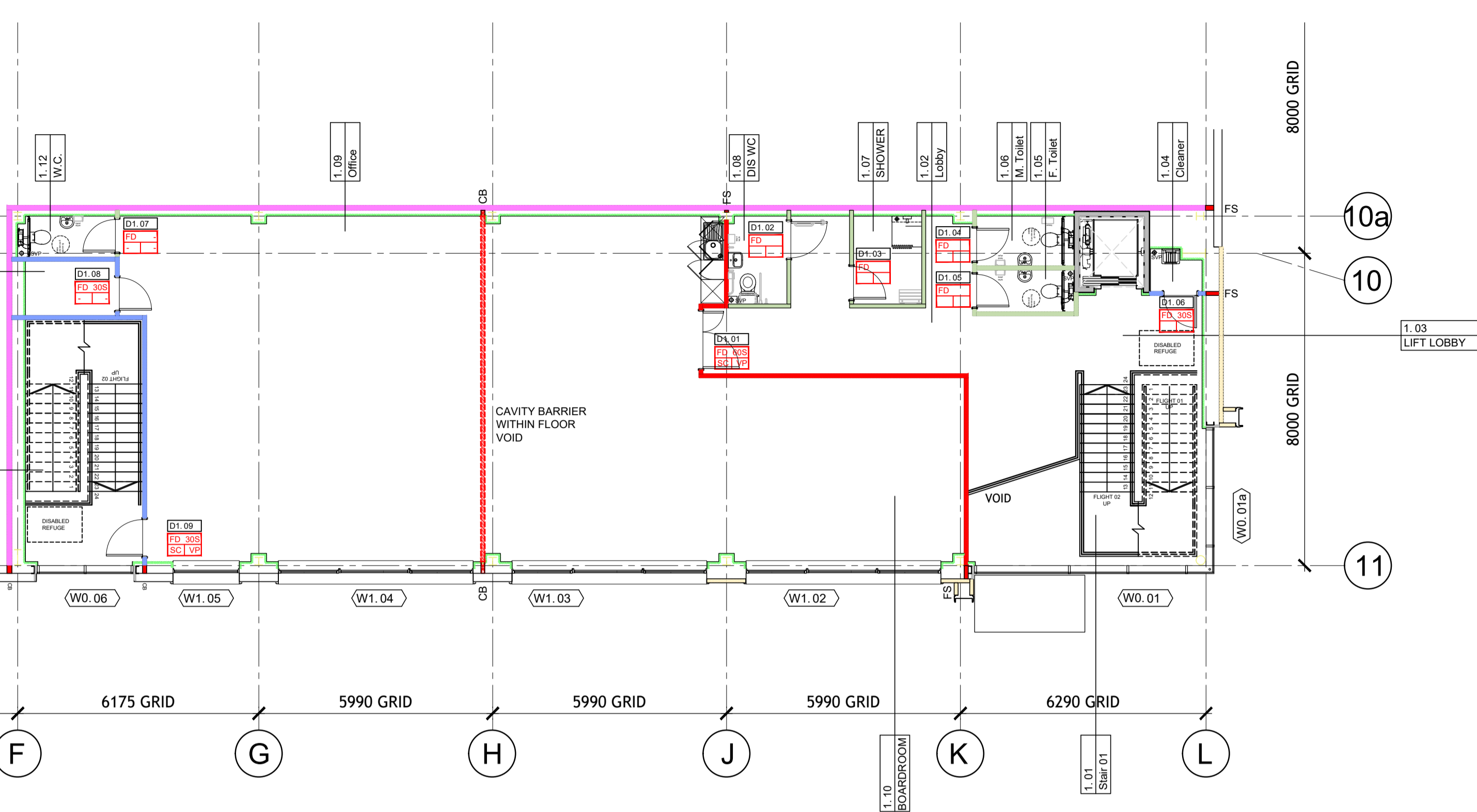

Description PART FIRST FLOOR PLAN. OFFICES.

Ref 1st

STAIR 2

STEEL OR PCC AMBULANT DISABLED ACCOMMODATION AND FIRE ESCAPE STAIRCASE TO COMPLY WITH THE REQUIREMENTS OF APPROVED DOCUMENTS B AND M OF THE BUILDING REGULATIONS. GRANO-FILLED STEEL STAIR TREADS TO REDUCE IMPACT SOUND. TOTAL RISE: 4000mm FLOOR TO FLOOR. 24 NO. EQUAL RISERS (each approx. 168mm.) 250mm GOINGS. CLEAR WIDTH BETWEEN HANDRAILS: APPROX. 1225mm. WIDTH ACROSS TREAD: 1200mm. BRUSHED STAINLESS STEEL BALUSTRADE SYSTEM, TOP FIXED TO STAIR STRINGER. TOUGHENED GLASS INFILL PANELS IN D-CLAMPS. ALL TO SPECIALIST DETAILS. BRUSHED STAINLESS STEEL HANDRAIL AT 1000mm ABOVE STAIR PITCH LINE. BRUSHED STAINLESS STEEL GUARDRAIL AT LANDINGS. 1100mm ABOVE FINISHED LANDING LEVEL. CONTRAST COLOUR NOSINGS.

WHERE WINDOWS SIT WITHIN AN UNLINED WALL WITHIN THE WAREHOUSE AREA, A PAINTED METAL FLASHING WILL BE UTILISED AT JAMB, HEAD AND SILL BETWEEN THE WINDOW FRAME AND STRUCTURAL RAILS TO CONCEAL ANY INSULATION.

STAIR 1

STEEL AMBULANT DISABLED ACCOMMODATION AND FIRE ESCAPE STAIRCASE TO COMPLY WITH THE REQUIREMENTS OF APPROVED DOCUMENTS B AND M OF THE BUILDING REGULATIONS. GRANO-FILLED STEEL STAIR TREADS TO REDUCE IMPACT SOUND. TOTAL RISE: 4000mm FLOOR TO FLOOR. 24 NO. EQUAL RISERS (each approx. 168mm.) 250mm GOINGS. CLEAR WIDTH BETWEEN HANDRAILS: APPROX. 1225mm. WIDTH ACROSS TREAD: 1200mm. BRUSHED STAINLESS STEEL BALUSTRADE SYSTEM, TOP FIXED TO STAIR STRINGER. TOUGHENED GLASS INFILL PANELS IN D-CLAMPS. ALL TO SPECIALIST DETAILS. BRUSHED STAINLESS STEEL HANDRAIL AT 1000mm ABOVE STAIR PITCH LINE. BRUSHED STAINLESS STEEL GUARDRAIL AT LANDINGS. 1100mm ABOVE FINISHED LANDING LEVEL. CONTRAST COLOUR NOSINGS.

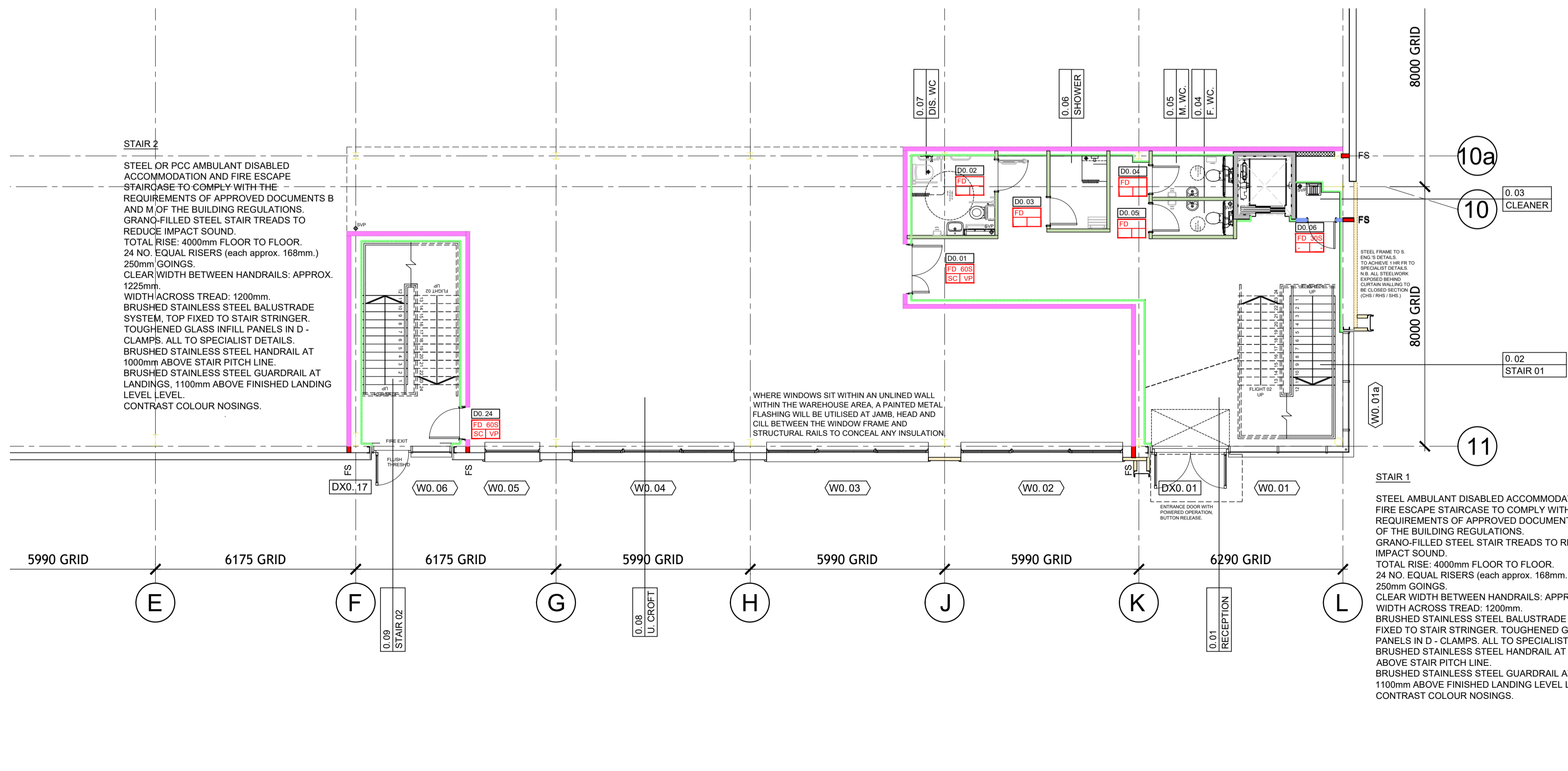

Description PART GROUND FLOOR PLAN. OFFICES. FOR CONTEXT REFER TO DRAWING REF. 130

Ref G

INTERNAL WALL CONSTRUCTION

|  |  |
|--|--|
| <b>Masonry walls</b>   | 100mm th. lightweight blockwork. Compressive strength to S. Eng.'s details.  |
| WT-B1  | 140mm th. lightweight blockwork. Compressive strength to S. Eng.'s details.  |
| WT-B1  | FOR FIRE RATING REFER TO FIRE STRATEGY PLANS DRAWING REFS 410 and 411.<br>Proprietary surface sealer to unfinished blockwork.<br>Specification subject to Manufacturer's requirements regarding wall height and required fire rating.  |
| <b>FINISHES TO MASONRY / CONCRETE WALLS.</b>                   |  |
| F0   | No board finish.   |
| F1   | 1 No. layer 15mm th. British Gypsum Duraline Wall board on adhesive dabs to one side only.   |
| F2   | 1 No. layer 15mm th. British Gypsum Duraline Wall board on adhesive dabs to both sides.  |
| N.B.   | Moisture Resistant plasterboard to be used in toilets and kitchens / tea points.   |
| <b>Metal stud and plasterboard partitions &amp; dry lining</b> | All metal stud and plasterboard partitions and dry lining to continue up to underside of floor deck or whitewall lid.<br>Moisture Resistant plasterboard to be used in toilets, kitchens and tea points.   |
| WT-P1  | Metal stud partition.<br>1 no. layer 15mm WallBoard both sides of 70mm metal studwork.<br>50mm Isover acoustic insulation to stud void.<br>British Gypsum GypWall Classic (or similar approved).<br>Board to be taper edged for taping and filling.<br>N.B. Construction to achieve 30 mins FR where shown on the Fire Strategy Plans  |
| WT-P2  | Metal stud partition (60 minutes FR).<br>1 no. layer 15mm WallBoard to one side of 70mm metal "T" section studwork.<br>British Gypsum GypLiner IWL (or similar approved).<br>Board to be taper edged for taping and filling.<br>N.B. Construction to achieve 60 mins FR where shown on the Fire Strategy Plans   |
| WT-P3  | Metal stud partition facing wall to conceal structural bracing. Column encasure and as lining to external wall.<br>1 no. layer 15mm WallBoard to one side of 70mm metal frame drylining.<br>British Gypsum GypLiner Universal (or similar approved).<br>Board to be taper edged for taping and filling.  |
| WT-P4  | Metal frame dry lining to lift shaft front wall.   |
| <b>Whitewall Construction</b>                                  | Eurobond Firemaster Wall Extra (or similar approved) vertically OR horizontally laid wall panels <b>TBC</b> by Specialist comprising stone wool core between steel facings complete with all necessary trims, flashings and fillers to provide a fire rated and air sealed enclosure. TO ACHIEVE 60 mins FR. Panels to be factory finished Colourcoat PE25 by Tata Steel White polyester RAL 9010. |
| WT-W1  | Division wall between offices and warehouse.   |

This drawing and the building works depicted are the copyright of BHP Design (UK) LTD. and may not be reproduced or amended except by written permission. No liability will be accepted for amendments made by other persons.  
The Contractor is to check and verify all building and site dimensions, levels and sewer invert levels at connection points before work starts. The Contractor is to comply in all respects with current Building Legislation, British Standard Specifications, Building Regulations, Construction (Design & Management) Regulations, Party Wall Act, etc. whether or not specifically stated on this drawing. This drawing must be read with and checked against any structural, geotechnical or other specialist documentation provided.  
This drawing is not intended to show details of foundations, ground conditions or ground contaminants. Each area of ground relied upon to support any structure depicted (including drainage) must be investigated by the Contractor. A suitable method of foundation should be provided allowing for existing ground conditions. Any suspect or fluid ground, contaminants on or within the ground, should be further investigated by a suitable expert. Any earthwork constructions shown indicate typical slopes for guidance only & should be further investigated by a suitable expert.  
Where existing trees are to be retained they should be subject to a full Arboricultural inspection for safety. All trees are to be planted to as to ensure they are a minimum of 5 metres from buildings and 3 metres from drainage and services. A suitable method of foundation is to be provided to accommodate the proposed tree planting.  
Sketch proposals are for illustrative purposes only & as such are subject to detailed site investigation including ground conditions/contaminants, drainage, design & planning/identity regulations. Sketch proposals may be based upon enlargements of OS sheets & visual estimations of existing site features. Accuracy will therefore need to be verified by survey. Sketch proposals have not been considered in respect of CDM Regulations.

**LEGEND**

|     |  |        |  |
|-----|--|--------|--|
| 1   | Detail ref on Drawing ref                        | S.O.P. | SETTING OUT POINT  |
| 121 | DOOR REF fire rating                             | W0.00  | EXTERNAL WINDOW REF  |
| CB  | CAVITY BARRIER 30/15mins FR integrity/insulation | FS     | FIRE STOPPING to match FR of floor or wall.                        |
| G   | GULLY  | Shwr   | SHOWER DRAIN   |
| SVP | SOIL AND VENT PIPE                               | SP     | STUB STACK OR DRAINAGE POPUP WITH AIR ADMITTANCE VALVE WHERE NOTED |
| RVP | RAINWATER PIPE                                   |        |  |

**ABBREVIATIONS**

|       |                           |       |                            |
|-------|---------------------------|-------|----------------------------|
| Nom.  | Nominal                   | U/S   | Underside of               |
| T.O.S | Top of steel              | T.O.  | Top of                     |
| S.O   | Structural Opening        | F.O.  | Face of                    |
| F.F.L | Finished Floor Level      | AFFL  | Above Finished Floor Level |
| S.S.C | Specialist Sub Contractor | S.S.L | Structural Slab Level      |
| EOB   | Edge Of Beam              |       |                            |

|            |  |            |       |
|------------|--|------------|-------|
| T4         | Updated for revised Tender Issue:      | 07.06.2023 | RJF   |
| T3         | Stair 2 spec note amended.             | 15.03.2023 | jmc   |
| T2         | Stair 2 relocated within office.       | 12.01.2023 | jmc   |
| T1         | Amended as Value Engineering Schedule. | 07.11.2022 | D.N.  |
| Revisions: | Amendment:                             | Date:      | Name: |

**bhpdesign**  
St. Paul's Place, 40 St. Paul's Square, Birmingham, B3 1FQ, United Kingdom  
t. +44(0)121 314 6618 f. +44(0)121 233 2716

TENDER

|             |  |
|-------------|--|
| CLIENT:     |  |
| PROJECT:    | SPECTRUM LOGISTICS PARK<br>ECKERSALL ROAD,<br>KINGS NORTON, BIRMINGHAM |
| TITLE:      | GENERAL ARRANGEMENT<br>Offices Ground and First Floor Plans<br>UNIT 3  |
| Scale:      | 1:100@A1   |
| Date:       | JUN 2022   |
| Drawn:      | D.N.   |
| Checked By: | D.N.   |
| Drw No:     | 17-110- T 131  |
| Revision:   | T4   |